

# Instruction Sheet

## Computer Monitor Stand #350300

### Column Assembly

Insert column center of base. Secure from bottom with washer, flat washer and machine screw.

### Monitor Tray Assembly

Attach the monitor tray to the plate at the top of the column using (4) flat washers and (4) lock nuts. Firmly tighten all nuts.

### Mounting the Plastic Suture Modules

Clean tray surface and bottom of laptop with isopropyl alcohol. Peel off one side of liner paper from the dual lock squares and affix to each corner on the bottom of the laptop. Place the laptop to confirm the desired location. Peel off the liner paper from the dual lock squares and place on tray. Press down firmly down to secure. Allow 15 minutes for adhesive to set before attempting to remove laptop from tray.

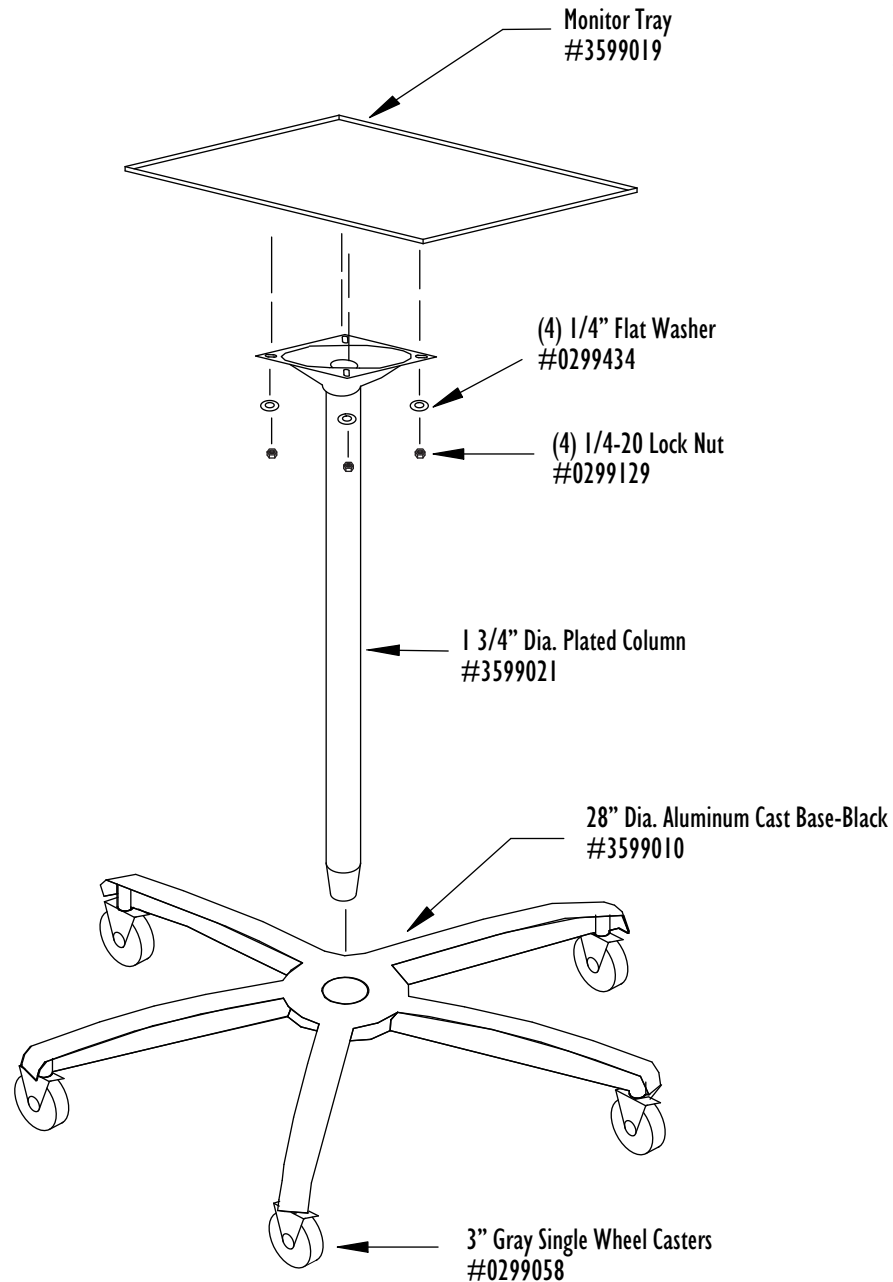

### Stand Accessories

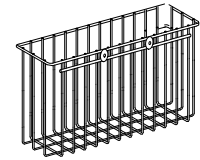

Transport Basket  
#350002



Wire Basket  
#350005