

Dear customer,

You have decided to purchase a Waldmann product. And you have surely made a good choice because Waldmann always endeavours to supply perfectly designed and reliable products.

We thank you for your trust in our products and hope that they will meet or better exceed your expectations.

Should nevertheless problems occur in conjunction with one of our products, please do not hesitate to contact one of our representatives or contact the factory directly.

Waldmann **W**
ENGINEER OF LIGHT.

Contents**Safety instructions** 17**General** 19**- Designated use** 19**- Abbreviations and symbols** 19**Mounting** 20**Connection** 21**Operation** 22**- Adjusting the articulation joints** 23**Maintenance and repair** 24**Care** 25**Disposal** 26**Technical data** 27

Safety instructions



DANGER

Danger caused by wrong mounting or handling!

Wrong mounting or handling of this unit can result in serious injuries or death.

- First read these instructions and, where appropriate, any other instructions and information attached to the unit! 
- Please observe the warnings and notes included in the instructions and attached to the unit!

DANGER

This symbol identifies items that may directly result in serious injuries or death in case of non-observance or wrong handling.

WARNING

This symbol identifies items that may result in serious injuries or death in case of non-observance or wrong handling.

CAUTION

This symbol identifies items that may result in injuries or material damage in case of non-observance or wrong handling.

NOTICE

This symbol identifies items that may result in material damage in case of non-observance or wrong handling.

Safety instructions



DANGER

Explosion hazard!

Operating the light in rooms subject to explosion hazards can trigger an explosion.

NOTICE

Risk of corrosion!

Operating the light in moist rooms can result in damage to the light!

- Operate in dry rooms not subject to explosion hazards only!

WARNING

Fire risk when exposed to sunlight

When exposed to sunlight, the magnifying glass can act as a focusing glass and ignite other objects.



- When not in use, cover the magnifier against solar radiation. To do this, use the bag included in the scope of delivery.

WARNING

Risk of transmitting diseases!

Insufficient disinfection can lead to transmission of diseases.

- Disinfect the luminaire at regular intervals!
- Make sure to comply with the requirements of the national institute for hygiene and disinfection.

General



Designated use:

Intended purpose:

Task light with integrated magnifier - Task lights are lights intended to illuminate a single workstation and are used in addition to general lighting equipment.

Place of use:

The luminaire may only be operated in dry rooms not subject to explosion hazards.

Operating mode:

The luminaire is designed for continuous operation.

Abbreviations and symbols



Safety or warning instructions!



Important information!



Unit corresponds to international protection class II (all-insulated)



Observe the disposal instructions!



The luminaire is suitable for mounting on normally inflammable surfaces



Fire risk!

LED

light-emitting diode



VDE approval



ENEC approval



SEV approval



CE Conformity mark

The manufacturer cannot be held liable for damage caused by using the unit for purposes contrary to the designated use or by ignoring safety instructions and warnings.

Mounting

Fig. 11

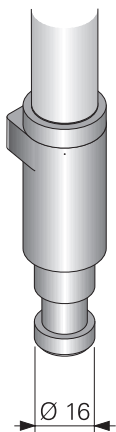

General

The light has been designed as mobile light.



Risk caused by a falling luminaire.

If not fastened properly, the luminaire may tilt or fall down.

- Mount luminaire, using suitable aids, at the selected mounting surface such that falling down is prevented.
- Lay cable in such a way that it cannot become damaged!
- When using mounting elements which have not been proposed by the manufacturer, the user has to verify their reliability!

Fastening elements

The luminaire is mounted on the selected surface using suitable accessories.

Suitable fastening means include desk clamp (see Fig. 12a), mounting flange (see Fig. 12b) or desk stand (see Fig. 12c). These and other adapter units can be purchased from the manufacturer.

Fig. 12a

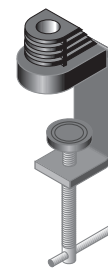

Fig. 12b

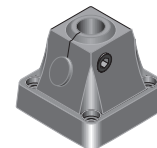
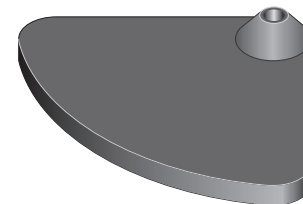
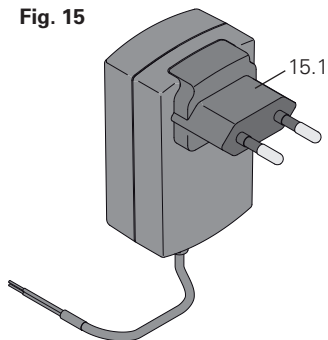

Fig. 12c



Connection

Fig. 15



NOTICE

Damage caused by wrong connection!

An unsuitable operating unit or a wrong connection can result in destroying the light.

- Operate the light with the operating units delivered by the manufacturer only.
- Before putting the light into operation, the user has to check whether the mains voltage is identical with the rated voltage and frequency specified on the rating plate.

Operating unit

As a standard feature, the luminaire is delivered with a plug-in power supply unit (see Fig. 15).

The plug-in power supply unit can be connected to any earthed or Euro socket.

To adapt it to the existing connector system e. g. for use in the US), the plug-in unit [15.1] can be exchanged.



Note

Upon request, additional plug parts (Fig. 16) will be enclosed with the light.

Fig. 16

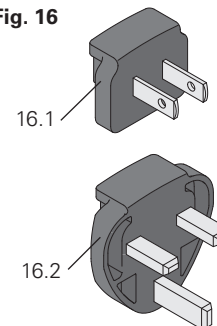

Operation

Fig. 21

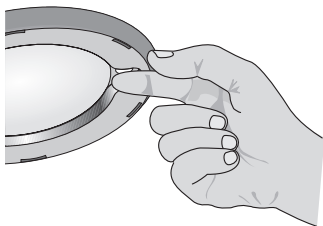

Switching On/Off

See Fig. 2 on page 3.

The light can be switched on and off via the sensor switch [2.4] on the light head [2.1].

Switching on

Touch the sensor for a brief moment -> the light will be switched on (switch-on value is the last dim value).

Switching off

Touch the sensor again for a brief moment -> the light will be switched off.

Dimming (RLLQ 63 R only)

See Fig. 2 on page 3.

The light can be switched on and off or dimmed continuously via the sensor switch [2.4] on the light head [2.1].

Dimming

Touch the sensor until the desired brightness is obtained.

Note: To reverse the dimming direction, briefly interrupt touching the sensor.

Overheating protection



Note

The luminaire is equipped with overheating protection. In case the luminaire is switched off because of a risk of overheating, the luminaire must first be cooled down, before being put back into operation.

Operation (continued)

Fig. 24



Positioning

See Fig. 2 on page 3.

The light head [2.1] is mounted to a flexible articulated hose [2.2]. This allows the light head to be rotated into virtually any desired direction.

NOTICE

Damage to the articulated hose.

Bends or too small a radius can damage the articulated hose.

- Avoid too small a radius or bending the articulated hose.

Fig. 25



Adjusting the articulation joints

See fig. 2 on page 3.

Depending on the design, the light is equipped with a different number of articulation joints (see fig. 25).

The articulation joints, except for the joint [2.3] directly on the light head [2.1], can be adjusted.

Each joint must be adjusted so that the light is - on the one hand - easily movable and - on the other hand - remains in the position adjusted by the user.

 **CAUTION**

Hazard to man and material caused when light tilts!

Articulation joints adjusted wrongly may cause the light to tilt!

- Adjust each articulation joint such that the adjustment cannot change by itself.

Maintenance and repair

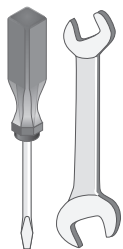

General

The luminaire is maintenance-free.

Repairs must be carried out by the manufacturer only!

WARNING

Danger due to electrical shock upon contact!

Maintenance or repair work carried out incorrectly may result in serious injuries or death.

- Maintenance and repair work to be carried out exclusively by the manufacturer!
- Disconnect the luminaire from the mains before carrying out any maintenance or repair work!
- Disconnect the damaged connecting cable immediately from the power supply and have it replaced by the manufacturer or by a qualified electrician.
- Only parts released by the manufacturer may be used as spare parts!

Replacing the lamp



The light is maintenance-free. A lamp replacement is not required. If nevertheless a lamp should break down, our service team can be reached at:

Care



General

Cleaning the transparent cover regularly guarantees a higher light yield.

Before use, the magnifier should be cleaned with an antistatic cloth.

Cleaning

NOTICE

Risk of damage through wrong care!

Wrong care may destroy the unit.

- Clean the transparent cover at regular intervals!
- Clean the luminaire parts with a cloth impregnated with a suitable household cleaning agent only!
- Make sure the agents used are compatible with paints and plastics! Do not use concentrated disinfectants or solvents or alcoholic liquids.
- Disinfection by spraying is not allowed.

Disinfection

⚠ WARNING

Risk of transmitting diseases!

Insufficient disinfection can lead to transmission of diseases.

- Disinfect the luminaire at regular intervals!
- Make sure to comply with the requirements of the national institute for hygiene and disinfection.

Disposal

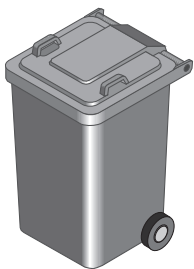

NOTICE

Environmental hazard!

Wrong disposal endangers our environment.

- Return the unit at the end of its useful life to the available recycling systems! 

Technical data

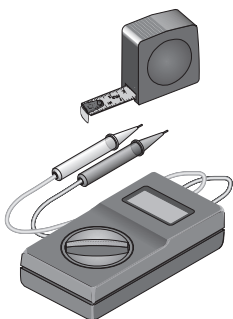

General data

Classification:
 - Protection class II
 - Protection type IP20

Operating mode:
 Continuous operation

Technical safety check:
 according to EN 60 598-1

Dimensions:

Light head
 approx. Ø 122 x 13 mm
 Magnifier 6.0 dpt.
 approx. Ø 72 mm

Column Type A
 approx. 233 + 400 + 124 mm
 Connecting cable
 approx. 2300 mm

Column Type B
 approx. 69 + 375 + 350 mm
 Connecting cable
 approx. 2000 mm

Electrical values

Rated voltage 100-240 V AC
 Frequency range 50/60 Hz
 Power consumption approx. 6 W

NOTICE

Risk of damage due to differences from the standard design.

If required, this series of units will be supplemented by further variants. The technical data may therefore be subject to modifications.

- Always observe the data and symbols given on the rating plate!