

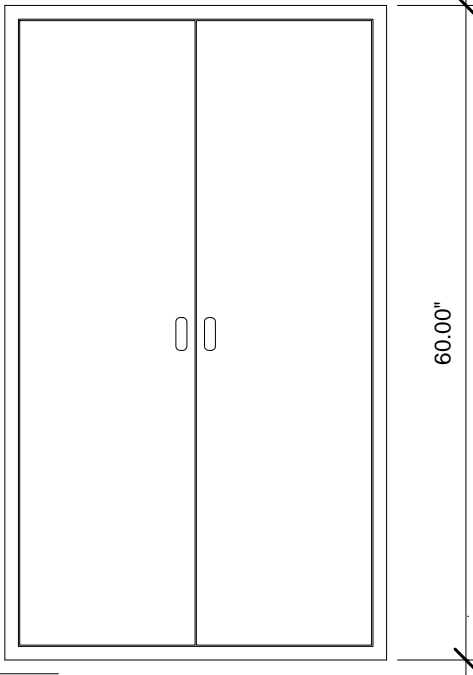

② Top
3/4" = 1'-0"

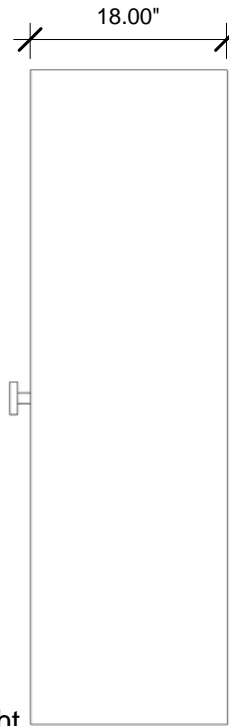

① Front
3/4" = 1'-0"



③ Right
3/4" = 1'-0"

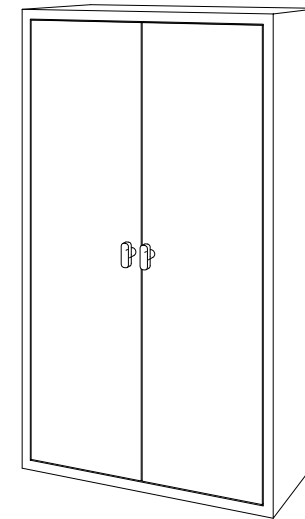

④ 3D View 1

Models TA35 and TA47 Table accessories cabinets include a removable stainless pegboard for storing endoscopy equipment, OR table accessories. Cabinet is furnished with solid, double pan doors, channel reinforced, hung on three semi-concealed stainless steel hinges.

PO#: _____ DATE: _____

APPROVAL: _____

TITLE: _____

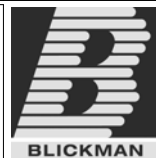

DRAWN	NAME	DATE
	JG	2-8-12
ENG APPR.		

MATERIAL
300 SERIES S/S

FINISH

APPRX WEIGHT = lbs

DO NOT SCALE DRAWING

BLICKMAN, INC
CLIFTON, NJ

TITLE:
TA35
CONSOLE CABINET

SIZE	DWG. NO.	REV
A	1718235000	

SCALE: 1:16

SHEET 1 OF 1

PROPRIETARY AND CONFIDENTIAL
THE INFORMATION CONTAINED IN THIS DRAWING IS THE SOLE PROPERTY OF BLICKMAN HEALTH INDUSTRIES. ANY REPRODUCTION IN PART OR AS A WHOLE WITHOUT THE WRITTEN PERMISSION OF BLICKMAN HEALTH INDUSTRIES IS PROHIBITED.

UNLESS OTHERWISE SPECIFIED:
DIMENSIONS ARE IN INCHES
BEND RADIUS = MTL THK.

TOLERANCES:
FRACTION: ± 1/32"
DECIMAL: ± .031"

5

4

3

2

1

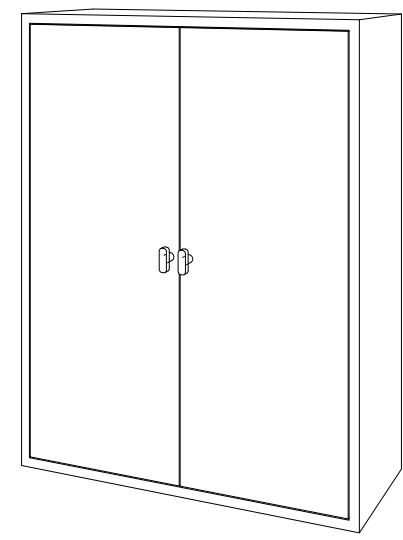
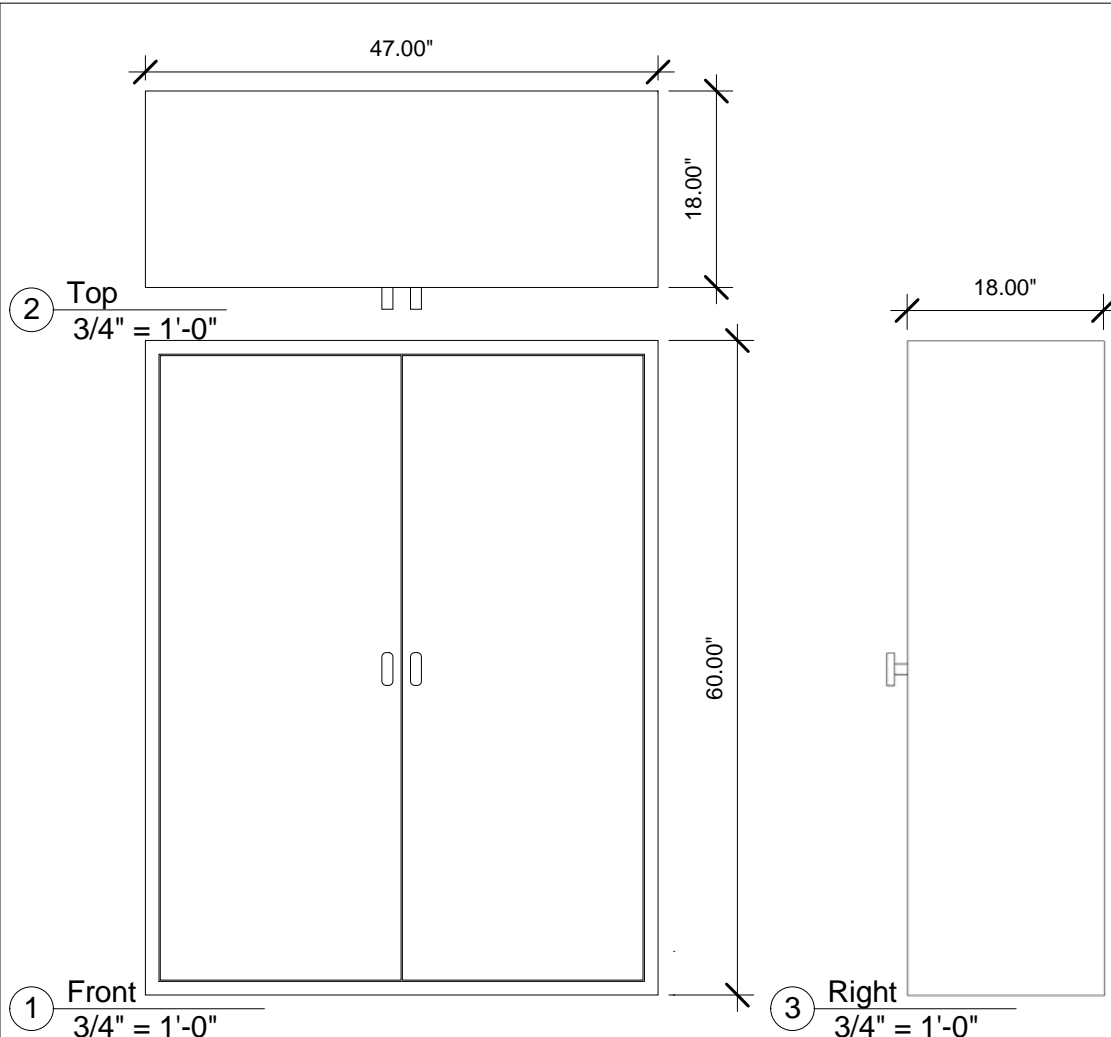

④ 3D View 1

Models TA35 and TA47 Table accessories cabinets include a removable stainless pegboard for storing endoscopy equipment, OR table accessories. Cabinet is furnished with solid, double pan doors, channel reinforced, hung on three semi-concealed stainless steel hinges.

PO#: _____ DATE: _____

APPROVAL: _____

TITLE: _____

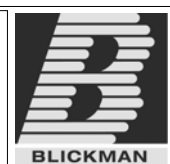

	NAME	DATE
DRAWN	JG	2-8-12
ENG APPR.		
MATERIAL		
300 SERIES S/S		
FINISH		
APPRX WEIGHT = lbs		
DO NOT SCALE DRAWING		

BLICKMAN, INC CLIFTON, NJ		
TITLE: TA47 CONSOLE CABINET		
SIZE A	DWG. NO. 1718247000	REV
SCALE: 1:16	SHEET 1 OF 1	

PROPRIETARY AND CONFIDENTIAL
THE INFORMATION CONTAINED IN THIS DRAWING IS THE SOLE PROPERTY OF BLICKMAN HEALTH INDUSTRIES. ANY REPRODUCTION IN PART OR AS A WHOLE WITHOUT THE WRITTEN PERMISSION OF BLICKMAN HEALTH INDUSTRIES IS PROHIBITED.

UNLESS OTHERWISE SPECIFIED:
DIMENSIONS ARE IN INCHES
BEND RADIUS = MTL THK.
TOLERANCES:
FRACTION: ± 1/32"
DECIMAL: ± .031"